



**22 Aphrodite Way, Burgess Hill, RH15 0XQ**  
**£445,000 Freehold**



22 Aphrodite Way, Burgess Hill, RH15 0XQ

£445,000 Freehold

- Immaculately presented
  - Plantation blinds
  - En-suite shower room
    - Parking
  - Ground floor cloak room
- 3 Bedroom family home
- Family kitchen breakfast room
  - Large patio and garden
  - New to the market
  - No onward chain

An extremely well presented and cared for 3 bedroom family home located on the very popular Croft Development in Burgess Hill.

The Croft development is located just off Kings Way in Burgess Hill, West Sussex. It is a great area for families, as it has plenty of local amenities, such as a nearby Co-Operative shop, several schools (Birchwood Grove, Woodlands Meed, and Burgess Hill School for Girls), St George's Park nature reserve, and Ditchling Common nearby. The development is also home to a wildlife area which is perfect for weekend walks.

This well designed 3 bedroom semi-detached family home offers plenty of living space throughout and inside you'll find a spacious entrance hall with cloakroom and a comfortable living room to the front, the hub of the house is the spacious fitted kitchen/ breakfast room with patio doors leading to the patio and rear garden plus a separate utility room adjacent. On the first floor you will find a spacious landing leading to all the bedrooms with two double bedrooms, the master bedroom enjoying an en-suite shower room, and a third good-sized single bedroom and a matching separate white bathroom suite.

The property also benefits from a good-sized side drive with parking spaces and an enclosed patio garden at the rear that is mainly laid to lawn.

**\*\*Please note the garage at the side of the property belongs to another property and is not associated in any way with 22 Aphrodite Way\*\***

Maintenance charge £300.00 PA

Council tax Band: D £2135.14

Heating: Gas

Windows: Double glazed

EPC: 'B'



## Floor Plans

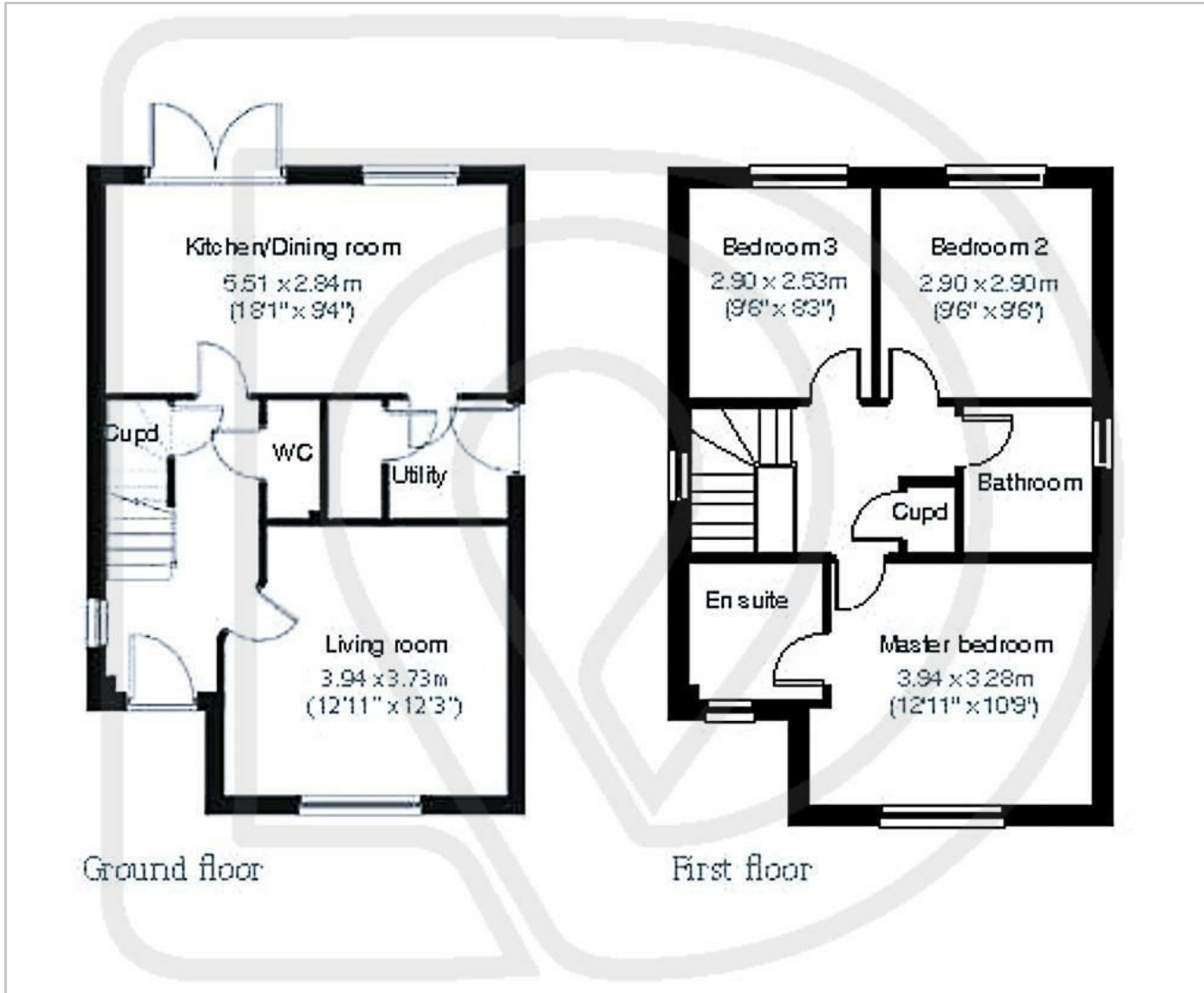

## Area Map

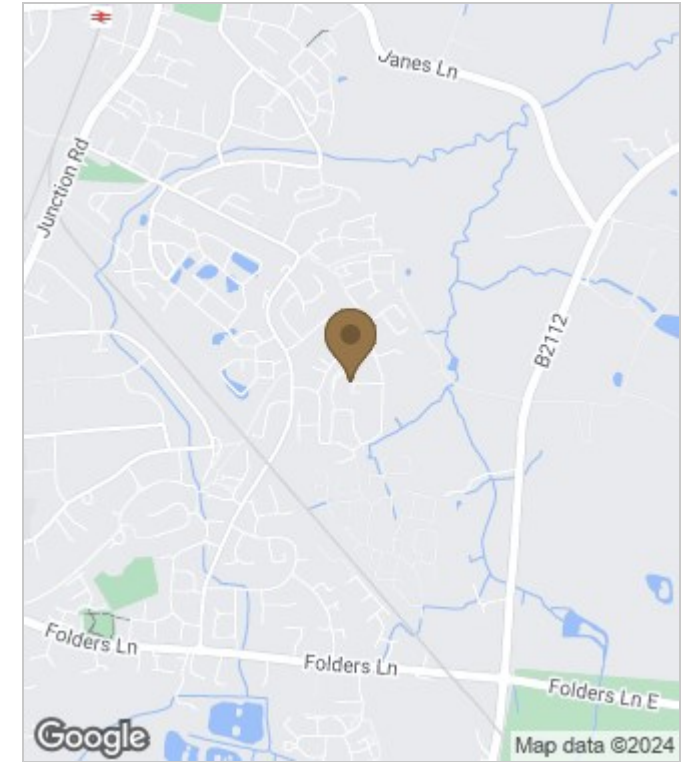

## Energy Performance Graph

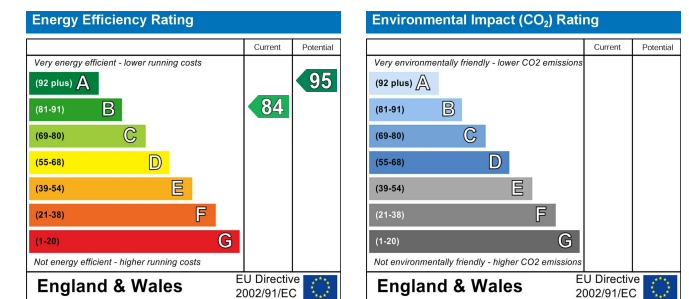

These particulars, whilst believed to be accurate are set out as a general outline only for guidance and do not constitute any part of an offer or contract. Intending purchasers should not rely on them as statements of representation of fact, but must satisfy themselves by inspection or otherwise as to their accuracy. No person in this firm's employment has the authority to make or give any representation or warranty in respect of the property.